

# EX Series external pod thrusters

Quick & easy retrofitting



EX SINGLE



EX DUAL



EX COMPACT

The externally mounted pod-based EX-series is a practical thruster solution for displacement and semi-planing boats between 6 and 18 m length, independently of hull form, hull material, propulsion and depth. These pod thrusters are an excellent choice where a tunnel bow thruster cannot be fitted, or as an extremely compact stern thruster.

The EX thrusters can be used in all types of vessels such as: sailing boats, catamarans, motorboats and houseboats made out of steel, aluminum, wood or GRP. The flexible mounting at the extreme bow of the boat hull allows a deeper position underwater which creates an optimal leverage compared to conventional thrusters. EX thrusters can, therefore, move larger boats by using nominally less power than conventional thrusters.

## Adapter

Made of hard rubber, optimizing the flow characteristics and ensuring tight and simple mounting



## Hollow shaft with cable routing

Made of steel with neoprene and rubber fittings to seal connection and perform as suspension as well

## Housing

Extreme robust, special coated aluminum housing. Seawater-resistant and redox-free

## 3-Blade Vector-Propeller

Purpose-designed to ensure highest efficiency

## Electric motor

Purpose-designed and special built motors guarantee outstanding performance. Up to 5 minutes nonstop operating time.



Optimally streamlined design

# Construction benefits



**Optimally streamlined design**  
Hydrodynamic shape, very short flow-channel and ideal placement reduce the water resistance to a fraction compared to conventional systems. There is no perceptible loss of speed.



**Easy installation**  
Requires drilling of only three small holes to assemble, which are sealed tightly with a special rubber sealant. No fiberglass work is necessary.



**Long duration**  
The external placement of the unit gives a more efficient water cooling and allows much longer duration per cycle of the unit than with traditional bow and stern thrusters.



**Optimal efficiency**  
Optimal efficiency results from a shorter transverse channel and ideal leverage which is created by deeper and more distant positioning away from the pivot point. Typically giving up to 40% higher efficiency than with conventional systems.

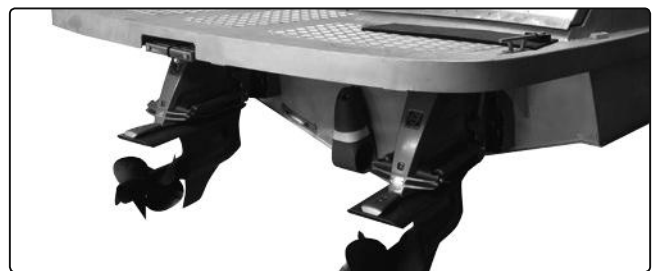
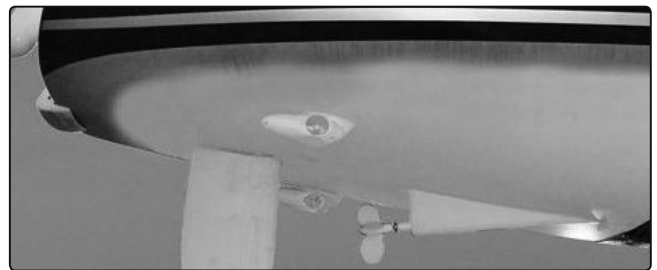
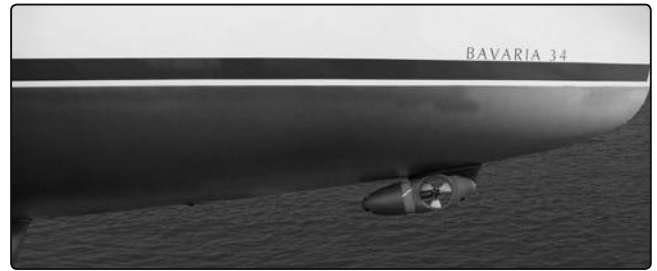

The experienced performance can be as high as 1.4 times the actual thrust.

- Due to the installation position more towards the very bow of the boat (1 - 1.5 m) the leverage increases by a minimum of 20%.
- Long and small transverse tunnels reduce thrust, on an average length of 60 - 70 cm, around 20%.
- Installation depth is 15-20cm (minimum) deeper under water (= no cavitation)

**The total of these three main performance benefits results in a higher efficiency of at least 40% compared to conventional thrusters! It is important to notice this, when comparing to tunnel thrusters.**

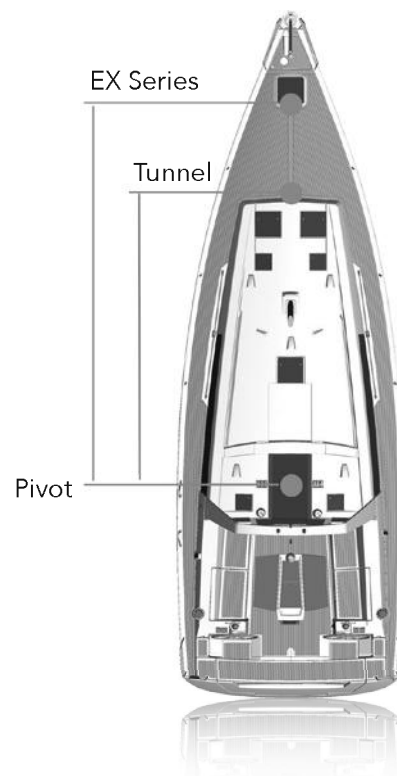

# EX-Series system overview

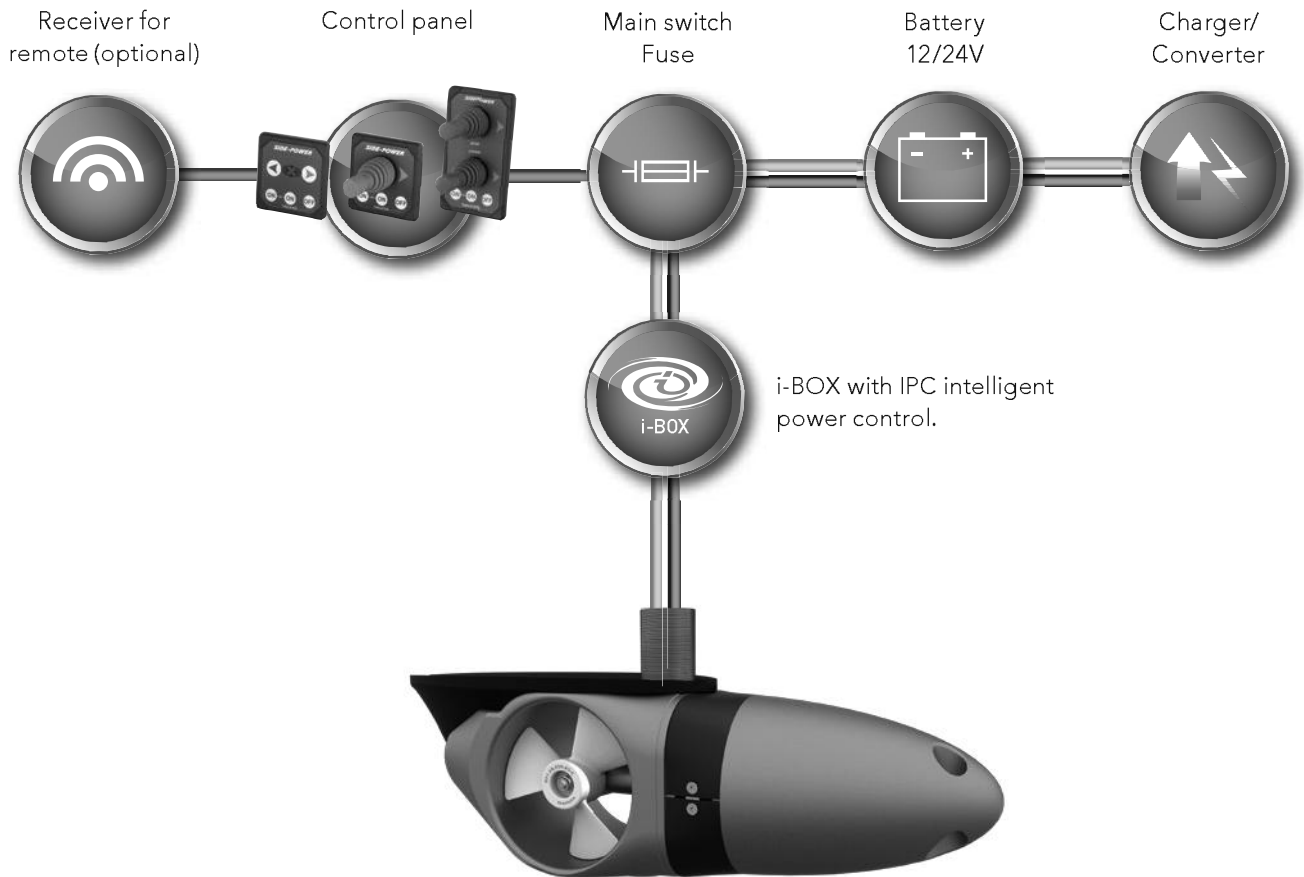

## EX-Series accessories



**Basic installation kit** with 2 mounting bolts, complete with sealing kit. (For EX COMPACT)

Item code:  
50151



**Installation kit** with streamline rubber adapter, complete with sealing kit (not for COMPACT)

Item code:  
50152



**GRP Adapter** for bow installation on V-shaped hulls.

Item code:  
50155



**Mooring protector** made of stainless steel for EX-Series motor housing, incl. fixing kit.

Item code:  
50154



**Charger & voltage transformer 12-24V, 10 A**, including charging voltage control (VST).

Item code:  
50211

# EX Series



EX Series	EX 35 S	EX 55 S	EX 75 S	EX 95 S
Thrust at 11.5V/23V* (kg • lbs)	25 • 55	40 • 88	53 • 117	67 • 148
Performance thrust** (kg • lbs)	35 • 77	55 • 121	74 • 163	95 • 210
Typical boat size (ft • m)	20' - 28' • 6 - 8.5	26' - 34' • 8 - 10.5	29' - 38' • 9 - 12	35' - 48' • 10 - 15
Tunnel I.D. (mm • in)	150 • 5.9"	150 • 5.9"	150 • 5.9"	150 • 5.9"
Propulsion system	Single	Single	Single	Single
Power at 10.5V/21V* (kw • Hp)	1.3 • 1.75	1.8 • 2.4	2.3 • 3.1	3.0 • 4.0
For DC system (V)	12	12	24	24
Weight (kg • lbs)	19,5 • 43	19,5 • 43	19,5 • 43	19,5 • 43
Min. Batt. Cap (CCA**12/24V)	170	225	150	190
Item Code 12V	EX35S	EX55S		
Item Code 24V			EX75S	EX95S



## Measurements

### EX Single

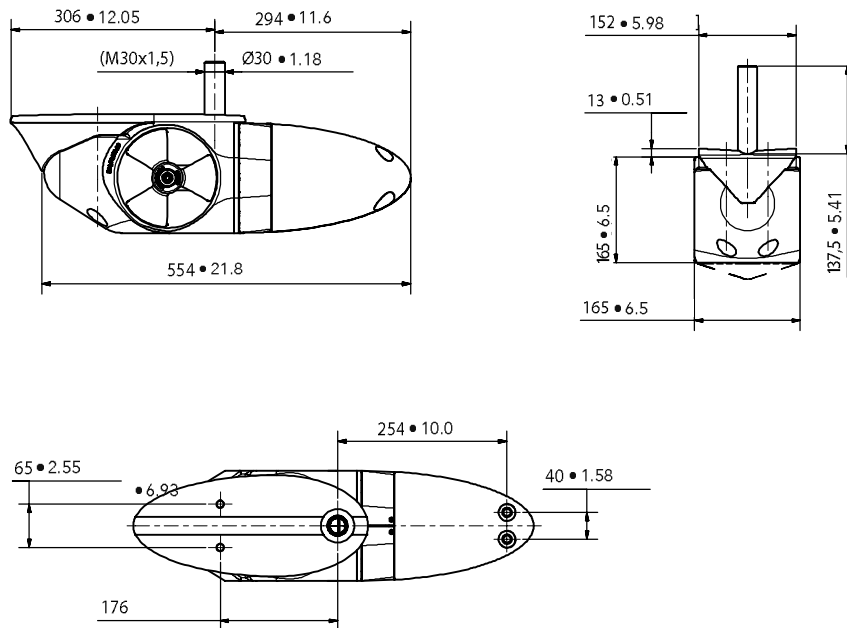

\*Note 2 - See page 47

