

SR Series retracting thrusters



SR Series*	SR		SRL			
	SR 80/185 T	SR 100/185 T	SRL 80/185 T	SRL 100/185 T	SRL 130/250 T	SRL 170/250 T
Thrust at 12V/24V* (kg • lbs)	96 • 212	116 • 256	96 • 212	116 • 256	160 • 352	210 • 462
Thrust at 10.5V/21V* (kg • lbs)	80 • 176	100 • 220	80 • 176	100 • 220	130 • 284	170 • 374
Typical boat size (ft • m)	35' - 48' • 10 - 15	35' - 55' • 12 - 17	35' - 48' • 10 - 15	35' - 55' • 12 - 17	42' - 62' • 13 - 19	50' - 70' • 15 - 22
Tunnel I.D. (mm • in)	185 • 7.3"	185 • 7.3"	185 • 7.3"	185 • 7.3"	250 • 9.8"	250 • 9.8"
Propulsion system	Twin	Twin	Twin	Twin	Twin	Twin Counter rot.
Power at 10.5V/21V* (kw • Hp)	4.4 • 6	6.3 • 8.4	4.4 • 6	6.3 • 8.4	6.5 • 8.7	8 • 10.7
For DC system (V)	12/24	12/24	12/24	12/24	12/24	24
Weight (kg • lbs)	31 • 68	44 • 97	31 • 68	44 • 97	82 • 181	88 • 194
Min. Batt. Cap (CCA**12/24V)	550/300	750/400	550/300	750/400	750/400	550
Installation	Mould-in	Mould-in	Flange	Flange	Flange	Flange
Item Code 12V	SR80/185T-12V	SR100/185T-12V	SRL80/185T-12V	SRL100/185T-12V	SRL130/250T-12V	SRL170/250T-12V
Item Code 24V	SR80/185T-24V	SR100/185T-24V	SRL80/185T-24V	SRL100/185T-24V	SRL130/250T-24V	SRL170/250T-24V
Item Code 12V PRO	SRP80/185T-12V	SRP100/185T-12V	SRLP80/185T-12V	SRLP100/185T-12V	SRLP130/250T-12V	SRLP170/250T-12V
Item Code 24V PRO	SRP80/185T-24V	SRP100/185T-24V	SRLP80/185T-24V	SRLP100/185T-24V	SRLP130/250T-24V	SRLP170/250T-24V



Measurements

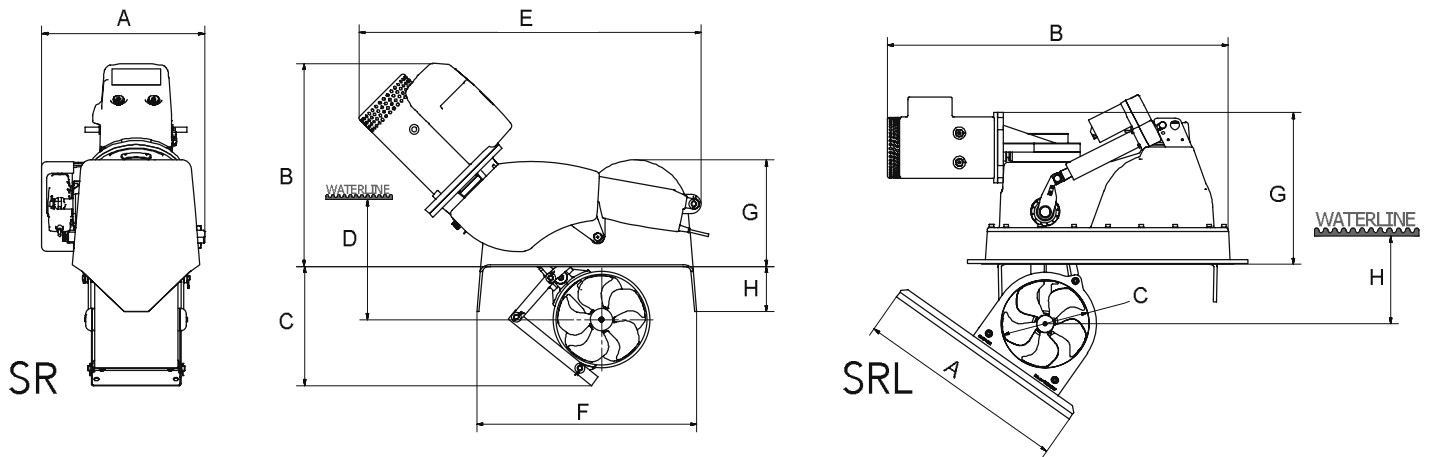

SR Thruster	A	B	C	D _{min}	E	F	G	H
(mm • in)								
SR80/185T	335 • 13.2	413 • 16.3	245 • 9.6	185 • 7.3	716 • 28.2	450 • 17.7	218 • 8.6	92 • 3.6
SR100/185T	335 • 13.2	467 • 18.4	245 • 9.6	185 • 7.3	752 • 29.6	450 • 17.7	218 • 8.6	92 • 3.6
SRL Thruster								
SRL80/185T	500 • 17.7	845 • 33.3	185 • 7.3	335 • 13.2	359 • 14.1	234 • 9.2	352 • 13.6	185 • 7.3
SRL100/185T	500 • 17.7	845 • 33.3	185 • 7.3	335 • 13.2	359 • 14.1	234 • 9.2	352 • 13.6	185 • 7.3
SRL130/250T	600 • 23.6	957 • 37.7	250 • 9.8	475 • 18.7	480 • 18.9	370 • 14.7	523 • 20.6	250 • 9.8
SRL170/250T	600 • 23.6	972 • 38.3	250 • 9.8	475 • 18.7	480 • 18.9	370 • 14.7	523 • 20.6	250 • 9.8

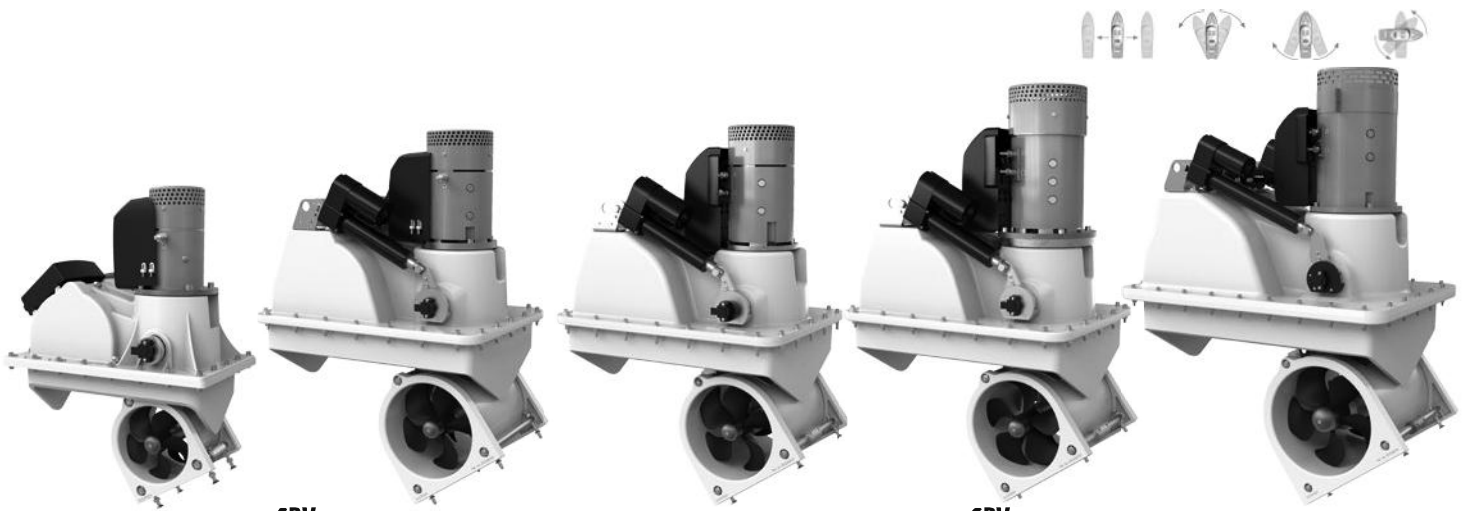

SRV

SRV

SRV 80/185 T

SRV 100/185 T

SRV 130/250 T

SRV 170/250 TC

SRV 210/250 TC

SRV 250/300 TC

SRV 300/300 TC

96 • 212	116 • 256	160 • 352	210 • 462	250 • 550	300 • 661	340 • 749
80 • 176	100 • 220	130 • 284	170 • 374	210 • 462	250 • 551	300 • 661
35' - 48' • 10 - 15	35' - 55' • 12 - 17	42' - 62' • 13 - 19	50' - 70' • 15 - 22	55' - 78' • 17 - 24	60' - 84' • 18 - 25	72' - 98' • 22 - 30
185 • 7.3"	185 • 7.3"	250 • 9.8"	250 • 9.8"	250 • 9.8"	300 • 11.8"	300 • 11.8"
Twin	Twin	Twin	Twin Counter rot.	Twin Counter rot.	Twin Counter rot.	Twin Counter rot.
4.4 • 6	6.3 • 8.4	6.5 • 8.7	8 • 10.7	11 • 14.5	11.4 • 15.5	15 • 20
12/24	12/24	12/24	24	24	24	24(48V motor)
31 • 68	44 • 97	82 • 181	88 • 194	112 • 247	117 • 257	120 • 265
550/300	750/400	750/400	550	650	700	- / 2x450 - 24V
Flange	Flange	Flange	Flange	Flange	Flange	Flange

SRV80/185T-12V

SRV100/185T-12V

SRV130/250T-12V

SRV170/250TC-24V

SRV210/250TC-24V

SRV250/300TC-24V

SRV300/300TC-48V

SRV80/185T-24V

SRV100/185T-24V

SRV130/250T-24V

SRV170/250TC-24V

SRV210/250TC-24V

SRV250/300TC-24V

SRV300/300TC-48V

SRVP80/185T-12V

SRVP100/185T-12V

SRVP130/250T-12V

SRVP170/250TC-24V

SRVP210/250TC-24V

SRVP250/300TC-24V

SRVP300/300TC-48V

SRVP80/185T-24V

SRVP100/185T-24V

SRVP130/250T-24V

SRVP170/250TC-24V

SRVP210/250TC-24V

SRVP250/300TC-24V

SRVP300/300TC-48V

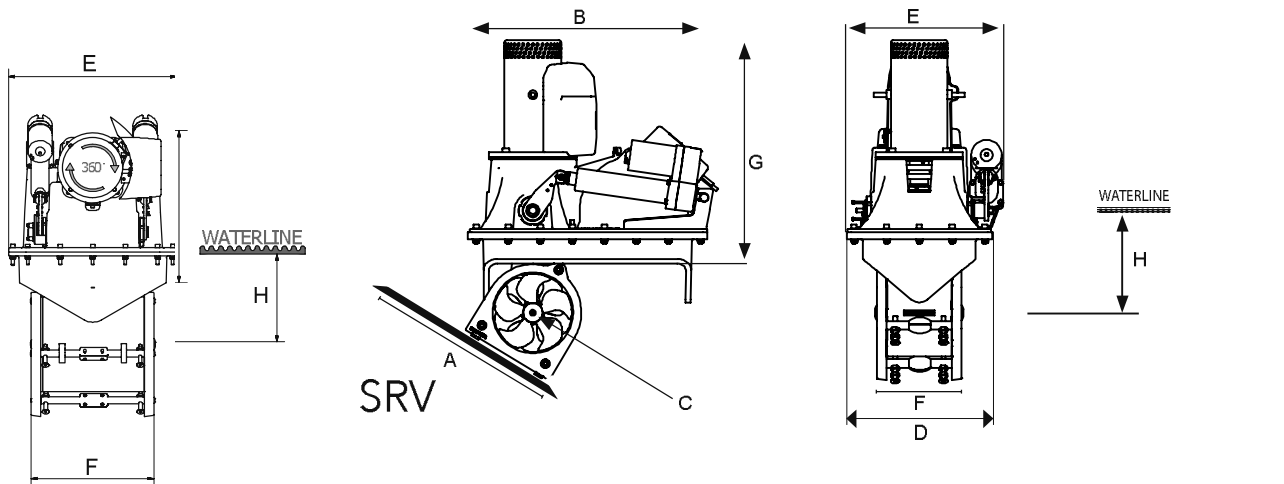

SRV Thruster

A B C D E F G G_(w. Hyd. motor) H_{min}

(mm • in)

SRV80/185T	450 • 17.7	564 • 22.2	Ø185 • 7.3	335 • 13.2	359 • 14.1	234 • 9.2	513 • 20.1	353 • 13.9	185 • 7.3
SRV100/185T	450 • 17.7	564 • 22.2	Ø185 • 7.3	335 • 13.2	359 • 14.1	234 • 9.2	535 • 21.1	353 • 13.9	185 • 7.3
SRV130/250T	600 • 23.6	688 • 27.1	Ø250 • 9.8	480 • 18.9	480 • 18.9	398 • 15.7	-	482 • 19.0	250 • 9.8
SRV170/250TC	600 • 23.6	688 • 27.1	Ø250 • 9.8	480 • 18.9	480 • 18.9	398 • 15.7	-	482 • 19.0	250 • 9.8
SRV210/250TC	600 • 23.6	688 • 27.1	Ø250 • 9.8	480 • 18.9	480 • 18.9	398 • 15.7	-	482 • 19.0	250 • 9.8
SRV250/300TC	709 • 27.9	843 • 33.2	Ø300 • 11.8	580 • 12.8	580 • 22.8	415 • 16.3	-	739 • 29.1	300 • 11.8
SRV300/300TC	709 • 27.9	843 • 33.2	Ø300 • 11.8	580 • 12.8	580 • 22.8	415 • 16.3	-	739 • 29.1	300 • 11.8

*Note 1 - See page 47